



**DavidJames**  
the estate agent

**Park View, Mapperley, Nottingham, NG3 5FD**

**Guide Price £170,000**

# About This Property

We are pleased to present this 2 double bedroom end-townhouse which creates a perfect opportunity for first-time buyers, conveniently located for an effortless commute into Nottingham city centre and offered to the market with no upward chain! As you step inside, you'll be greeted by a bright and spacious lounge which sits open plan to the dining kitchen, boasting ample space for freestanding appliances, creating a versatile area for cooking and dining. Upstairs, you'll find two generous double bedrooms and a well appointed shower room with a 3-piece white suite and an electric Triton shower. The low maintenance enclosed rear garden provides a private outdoor space and furthermore, this property includes a garage in a communal block just a short walk away. Don't miss out on this fantastic opportunity to own a comfortable and conveniently located home!



- End-townhouse
- Ideal for first-time buyers
- Short commute to Nottingham city centre
- Bright and spacious lounge
- Open plan dining kitchen with space for freestanding appliances
- Two double bedrooms
- Shower room with electric Triton shower
- Low maintenance enclosed rear garden
- Garage in a communal block nearby
- Sold with no upward chain



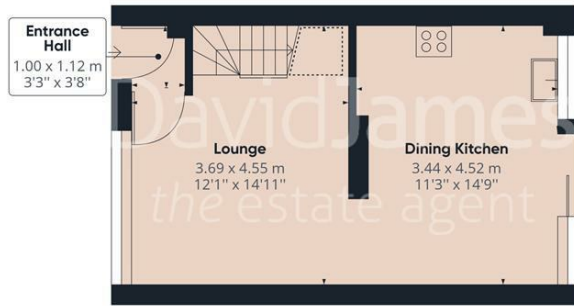

Floor 0

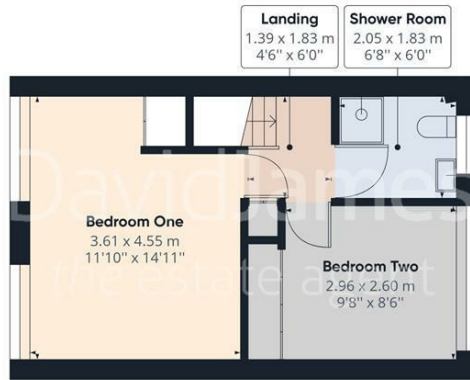

Floor 1



Approximate total area<sup>(1)</sup>  
65.09 m<sup>2</sup>  
700.64 ft<sup>2</sup>

Reduced headroom  
0.64 m<sup>2</sup>  
6.89 ft<sup>2</sup>

(1) Excluding balconies and terraces

Reduced headroom  
(below 1.5m/4.92ft)

While every attempt has been made to ensure accuracy, all measurements are approximate, not to scale. This floor plan is for illustrative purposes only.

GIRAFFE360

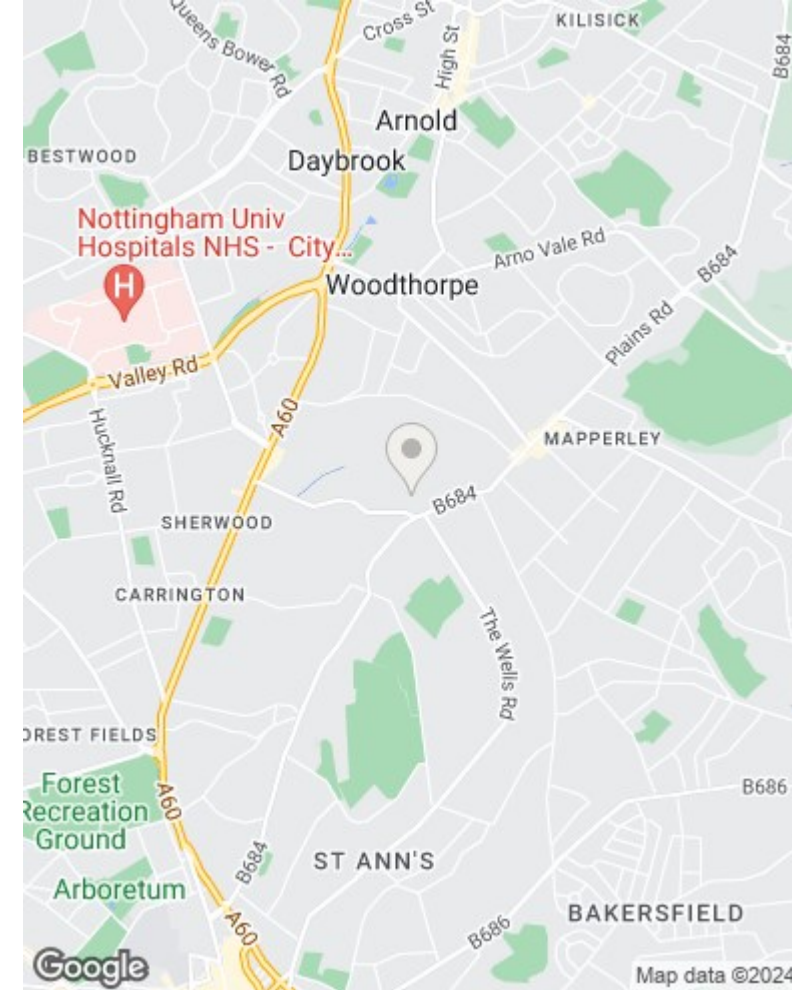

These particulars are produced in good faith, are set out as a general guide only and do not constitute any part of a contract. No person in the employment of David James Estate Agents Ltd has any authority to make any representation whatsoever in relation to the property. All services, together with electrical fittings or fitted appliances have NOT been tested. All the measurements given in the details are approximate. Floor plans are for illustrative purposes only and are not drawn to scale. The position and size of doors, windows, appliances and other features are approximate only. The photographs of this property have been taken with a 10mm wide-angle lens. No responsibility can be accepted for any loss or expense incurred in viewing. If you have a property to sell you may wish to take advantage of our free valuation service. David James Estate Agents have established professional relationships with third-party suppliers for the provision of services to Clients. As remuneration for this professional relationship, the agent receives referral commission from the third-party company. David James Estate Agents receives the following commission from each third party supplier on a per referral basis: W A Barnes Ltd: £60 including VAT. All Moves UK Ltd: 18% including VAT of the invoice total (£107 including VAT average). MoveWithUs Limited: £188 including VAT (average).

**Council Tax Band: A**  
**Nottingham City Council**  
**Freehold**

**DavidJames**  
the estate agent

David James Estate Agents  
45b Plains Road, Nottingham, NG3 5JU  
t: 0115 962 4213 e: mapperley@david-james.com

